

# CROMPTON GREAVES



## NEMA Frame

Foot Mounted

3PH, 60 Hz

Aluminum Construction



### Features:

- NEMA MG1-PART 31 Inverter Duty
- 15:1 Constant Torque
- Service Factor 1.15
- IP55 degree of protection
- VPI Impregnation
- Internal Tropicproof
- F1, F2, & F3 convertible
- Class F insulation
- Dual Rated 60/50Hz
- Split conduit box is 90° rotatable
- Warranty: 3 Years
- CSA approved for Class I ; Division 2 ; Groups A,B,C & D,T3

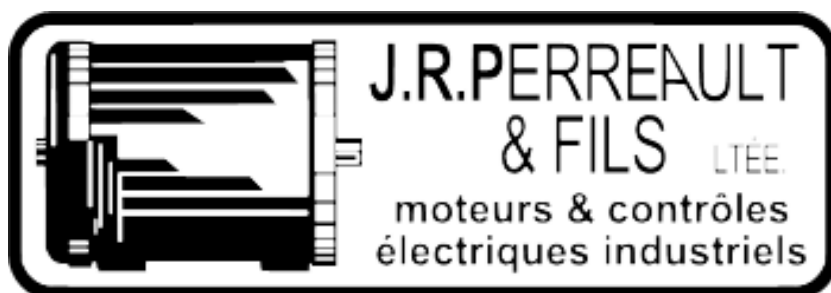

TELEPHONE: 1-800-463-0400

[www.jrperreault.com](http://www.jrperreault.com)

# CROMPTON GREAVES ALUMINIUM

MOTEURS HAUT RENDEMENT CERTIFIÉ CSA (USA)  
 BÂTI EN FONTE SERVICE FACTOR JUSQU'À 1.40  
 ISOLATION DE CLASSE F (155°C)  
 ELEVATION DE TEMPERATURE DE CLASSE B (90°C)  
 MOTEURS COMPLETEMENT FERMÉS AUTO-VENTILÉS IP55  
 INVERTER DUTY: 5:1 CONSTANT ET 10:1 VARIABLE, NEMA MG-1, PART 31  
 PROCÉDÉ DE VERNISSAGE V.P.I.  
 ROULEMENT ET BOITE DE RACCORD SUR-DIMENSIONNÉS  
 BASE AMOVIBLE ET PIVOTABLE  
 CERTIFIÉ CLASSE 1, DIVISION 2, GROUPE A,B,C,D



HIGH EFFICIENCY MOTORS CSA CERTIFIED (USA)  
 CAST IRON FRAME WITH SERVICE FACTOR UP TO 1.40  
 INSULATION CLASS F (155°C)  
 CLASS B TEMPERATURE RISE (90°C)  
 TOTALLY ENCLOSED FAN COOLED MOTORS IP 55  
 INVERTER DUTY: 5:1 CONSTANT AND 10:1 VARIABLE, NEMA MG-1, PART 31  
 V.P.I. PROCESS APPLIED  
 OVERSIZED BEARINGS AND TERMINAL BOX  
 REMOVABLE AND ROTABLE BASE  
 CERTIFIED CLASSE 1, DIVISION 2, GROUP A,B,C,D

TYPE	MODEL	VOLT CODE	HP	RPM	FRAME	ENCL	LISTE
CGA-	0.33/56C2-	XXX	1/3	3600	56C	TEFC	273.00 \$
CGA-	0.33/56C4-	XXX	1/3	1800	56C	TEFC	259.00 \$
CGA-	0.5/56C2-	XXX	1/2	3600	56C	TEFC	284.00 \$
CGA-	0.5/56C4-	XXX	1/2	1800	56C	TEFC	271.00 \$
CGA-	0.75/56C2-	XXX	3/4	3600	56C	TEFC	298.00 \$
CGA-	0.75/67C4-	XXX	3/4	1800	56C	TEFC	285.00 \$
CGA-	1.0/56C2	XXX	1	3600	56C	TEFC	329.00 \$
CGA-	1.0/56C4-	XXX	1	1800	56C	TEFC	315.00 \$
CGA-	1.5/56C2-	XXX	1.5	3600	56C	TEFC	372.00 \$
CGA-	1.5/56C4-	XXX	1.5	1800	56C	TEFC	355.00 \$

TYPE	MODEL	VOLT CODE	HP	RPM	FRAME	ENCL	LISTE
CGA-	143T2-	XXX	1	3600	143T	TEFC	458.00 \$
CGA-	145T4-	XXX	1	1800	143T	TEFC	460.00 \$
CGA-	145T2A-	XXX	1.5	3600	145T	TEFC	469.00 \$
CGA-	145T4A-	XXX	1.5	1800	145T	TEFC	475.00 \$
CGA-	145T2B-	XXX	2	3600	145T	TEFC	498.00 \$
CGA-	145T4B-	XXX	2	1800	145T	TEFC	502.00 \$
CGA-	182T2-	XXX	3	3600	182T	TEFC	688.00 \$
CGA-	182T4-	XXX	3	1800	182T	TEFC	690.00 \$
CGA-	184T2A-	XXX	5	3600	184T	TEFC	769.00 \$
CGA-	184T4-	XXX	5	1800	184T	TEFC	777.00 \$
CGA-	184T2B-	XXX	7.5	3600	184T	TEFC	1 080.00 \$
CGA-	215T2-	XXX	7.5	3600	213T	TEFC	1 077.00 \$
CGA-	213T4-	XXX	7.5	1800	213T	TEFC	1 098.00 \$
CGA-	215T2A-	XXX	10	3600	215T	TEFC	1 205.00 \$
CGA-	215T4-	XXX	10	1800	215T	TEFC	1 252.00 \$
CGA-	215T2B-	XXX	15	3600	215T	TEFC	1 728.00 \$

VOLT CODE:  
 2X4= 230/460 VOLTS  
 575= 575 VOLTS

C FACE	140TC	90.00 \$
C FACE	180TC	125.00 \$
C FACE	210TC	150.00 \$

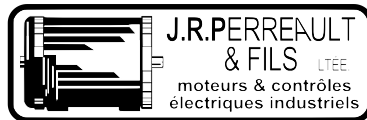

CODE:	CGA
DISC:	

**NEMA Aluminum - TEFC**  
**CROMPTON GREAVES**      **Dimensions Frame Sizes 56 - 286**

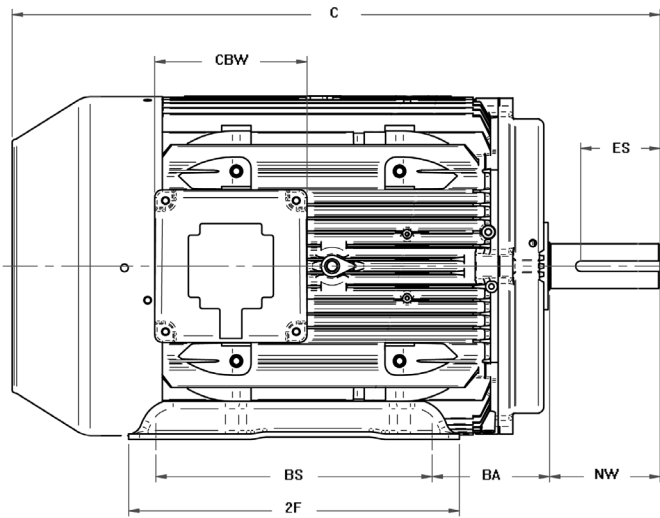
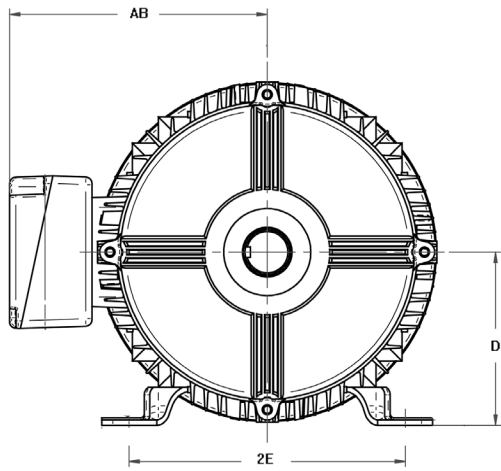

**FOOT MOUNTED**

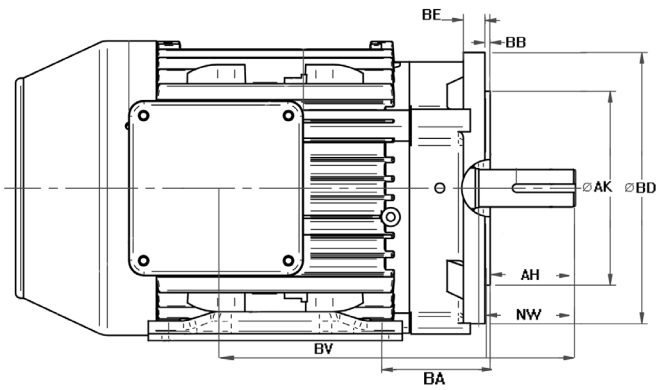
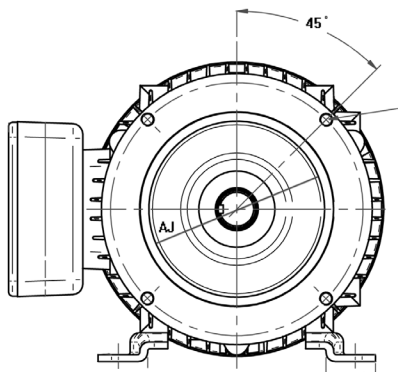

**C FACE MOUNTED**

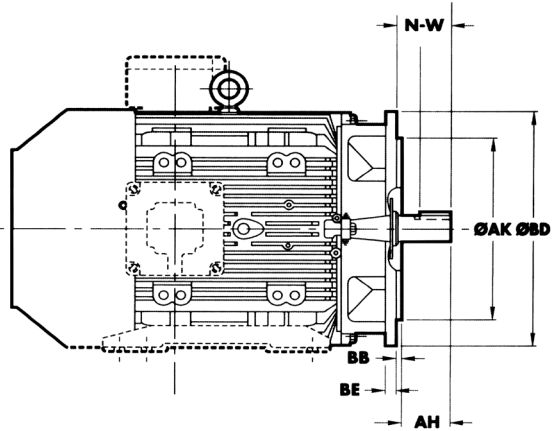
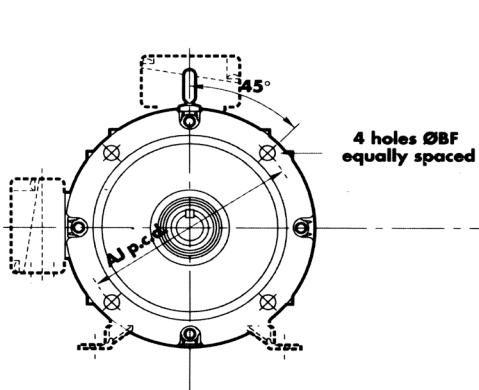

**D FLANGE MOUNTED**

FRAME	D	E	2E	2F	BA	H	AA	AB	C	BS	CBH	CBW
56	3.50	2.43	4.87	3.0	2.75	0.34	0.50	5.187	12.25	2.18	4.06	4.06
143T	3.50	2.75	5.5	4.0	2.25	0.34	0.75	5.50	14.60	4.0	4.06	4.06
145T	3.50	2.75	5.5	5.0	2.25	0.34	0.75	5.50	14.60	4.0	4.06	4.06
182T	4.50	3.75	7.5	4.5	2.75	0.50	0.75	6.57	17.80	4.14	5.0	5.0
184T	4.50	3.75	7.5	5.5	2.75	0.50	0.75	6.57	17.80	4.14	5.0	5.0
213T	5.25	4.25	8.5	5.5	3.50	0.50	1.0	7.40	19.32	4.53	5.0	5.0
215T	5.25	4.25	8.5	7.0	3.50	0.50	1.0	7.40	19.32	4.53	5.0	5.0
254T	6.25	5	10	12	4.25	0.59	1.25	9.45	23.44	8.26	5.51	5.51
256T	6.25	5	10	12	4.25	0.59	1.25	10.56	23.44	10	6.85	6.85
284T	7	5.5	11	12.95	4.75	0.23	1.25	10.23	26.40	11	5.51	5.51
284TS	7	5.5	11	12.95	4.75	0.23	1.25	10.23	25.02	11	5.51	5.51
286T	7	5.5	11	12.95	4.75	0.23	1.25	10.23	26.40	11	5.51	5.51
286TS	7	5.5	11	12.95	4.75	0.23	1.25	10.23	25.02	11	5.51	5.51

FRAME	D FLANGE MOUNT						C FACE MOUNT					
	AJ	AK	BB	BD	BE	BF	AJ	AK	BB	BD	BF	BV
56	-	-	-	-	-	-	5.87	4.50	0.12	6.50	0.37	-
143T	10	9	0.25	11	0.50	0.53	5.87	4.50	0.12	6.50	0.37	-
145T	10	9	0.25	11	0.50	0.53	5.87	4.50	0.12	6.50	0.37	-
182T	10	9	0.25	11	0.46	0.53	7.25	8.50	0.25	9.0	0.50	7.01
184T	10	9	0.25	11	0.46	0.53	7.25	8.50	0.15	9.0	0.50	7.01
213T	10	9	0.25	11	0.46	0.53	7.25	8.50	0.25	9.0	0.50	8.28
215T	10	9	0.25	11	0.46	0.53	7.25	8.50	0.25	9.0	0.50	8.28
254T	12.5	11	0.25	14	0.59	0.812	7.25	8.5	0.25	9.84	0.5	11.78
256T	12.5	11	0.25	14	0.59	0.812	7.25	8.5	0.25	9.84	0.5	11.78
284T	12.5	11	0.25	14	0.59	0.812	9	10.5	0.25	11.25	0.5	12.89
284TS	12.5	11	0.25	14	0.59	0.812	9	10.5	0.25	11.25	0.5	12.89
286T	12.5	11	0.25	14	0.59	0.812	9	10.5	0.25	11.25	0.5	12.89
286TS	12.5	11	0.25	14	0.59	0.812	9	10.5	0.25	11.25	0.5	12.89

SHAFT DRIVE END						
FRAME	AH	ES	N-W	R	S	U
56	2.062	1.375	1.875	0.517	0.187	0.625
143T	2.125	1.406	2.25	0.771	0.187	0.875
145T	2.125	1.406	2.25	0.771	0.187	0.875
182T	2.625	1.75	2.75	0.986	0.25	1.125
184T	2.625	1.75	2.75	0.986	0.25	1.125
213T	3.125	1.75	3.375	1.201	0.312	1.375
215T	3.125	1.75	3.375	1.201	0.312	1.375
254T	3.75	2.87	4	1.416	0.375	1.625
256T	3.75	2.87	4	1.416	0.375	1.625
284T	4.375	3.25	4.625	1.591	0.5	1.875
284TS	3	1.87	3.25	1.416	0.375	1.625
286T	4.375	3.25	4.625	1.591	0.5	1.875
286TS	3	1.87	3.25	1.416	0.375	1.625

NEMA Brake Motors	
Frame Size	'C' dimension Additional Length
56	2.875"
143/5T	4.0"
182/4T	3.5"
213/5T	3.75"

NOTE: All dimensions in inches

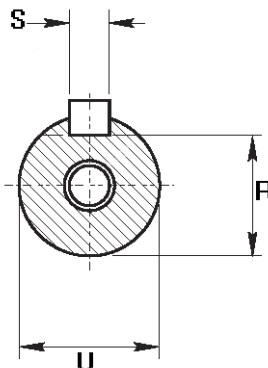

**Performance**  
**CROMPTON GREAVES NEMA Premium Aluminum - TEFC**

Product Number	HP	KW	Full Load RPM	Frame	F.L. Amps		Efficiency			Power Factor			LRT %	L.R. Amps		BDT %	KVA Code
					460V	575V	FL	0.75	0.5	FL	0.75	0.5		460V	575V		
	0.25	0.2	1740	56	0.5	0.4	75.5	74	72	0.63	0.57	0.46	250	2.5	2	300	J
			1140	56	0.7	0.5	72	70	61	0.50	0.44	0.35	220	2.7	2.2	260	K
			820	56	0.8	0.7	57.5	52	42	0.47	0.43	0.35	200	2.3	1.9	250	J
	0.33	0.25	3400	56	0.6	0.5	57.5	55	45	0.86	0.79	0.71	330	3.4	2.7	320	K
			1700	56	0.6	0.5	80	80	73	0.72	0.62	0.50	200	2.5	2	285	H
			1140	56	0.9	0.7	62	59	53	0.55	0.46	0.36	240	3.5	2.8	270	J
			820	56	1.2	0.9	62	57	48	0.45	0.40	0.33	210	3.1	2.5	265	J
	0.5	0.37	3400	56	0.8	0.7	68	65	60	0.83	0.79	0.71	250	4.2	3.4	265	
			1700	56	0.9	0.7	72	72	65	0.72	0.62	0.50	200	4.1	3.3	250	H
			1120	56	1.2	1	70	70	64	0.55	0.46	0.36	220	4.2	3.4	240	H
			820	56	1.5	1.2	68	63	51	0.45	0.40	0.33	220	4.3	3.5	250	H
	0.75	0.55	3400	56	1.1	0.9	75.5	71	64	0.82	0.79	0.70	230	6.6	5.3	260	H
			1700	56	1.4	1.1	78.5	77	75	0.68	0.61	0.48	220	6.4	5	280	H
			1140	56	1.5	1.2	70	68	64	0.63	0.56	0.43	200	5.8	4.5	225	G
			820	143T	1.7	1.4	72	69	64	0.57	0.50	0.40	240	6.5	5.2	280	H
	1	0.75	3500	56	1.4	1.1	78.5	77	72	0.84	0.78	0.68	240	8.8	7	300	H
			1720	56	1.6	1.3	80	80	77	0.75	0.65	0.49	250	9.1	7.3	270	J
			1720	143T	1.4	1.1	77	77	72	0.85	0.74	0.55	280	9.1	7.3	300	J
			1150	145T	1.5	1.2	85.5	85	82	0.72	0.65	0.52	300	11.2	9	320	K
	1.5	1.1	3500	56	2.1	1.7	81.5	80	75.5	0.82	0.77	0.66	300	14.7	11.8	320	J
			1750	56	2.5	2	78.5	80	77	0.72	0.61	0.50	270	14.9	12	330	J
			3400	143T	1.9	1.5	84	84.1	83.5	0.86	0.82	0.75	370	15	12	400	J
			1710	145T	2.1	1.6	86.5	86	84.5	0.76	0.67	0.56	420	16.5	13.2	400	K
			1130	182T	2.2	1.8	87.5	87	84.7	0.73	0.63	0.50	310	15.4	12.6	250	K
	2	1.5	3400	145T	2.6	2	85.5	85.8	85.5	0.86	0.82	0.74	300	19.5	15.6	330	J
			1710	145T	2.9	2.3	86.5	86	84.5	0.74	0.65	0.52	280	19	15.2	300	J
			1130	184T	3	2.4	88.5	86	86	0.71	0.65	0.51	280	19.8	15.8	240	J
	3	2.2	3480	182T	3.5	2.8	86.5	85.8	82.5	0.91	0.85	0.78	410	41.6	33.3	560	J
			1750	182T	3.9	3.1	89.5	89	86.5	0.79	0.71	0.57	250	29.2	23.4	300	N
			1140	213T	4.2	3.4	89.5	89.5	88.3	0.74	0.73	0.60	310	27	22	230	J
	5	3	3460	184T	5.8	4.6	88.5	88.3	87.5	0.92	0.88	0.82	380	61.5	49.2	460	L
			1740	184T	6.3	5	89.5	89.5	89	0.83	0.76	0.64	210	44	35.2	260	H
			1150	215T	7.1	5.7	89.5	90.1	89.3	0.74	0.75	0.64	230	45	36	220	J
	7.5	5.5	3480	213T	8.4	6.7	89.5	89.8	89.7	0.92	0.89	0.82	330	81	64.8	480	K
			1740	213T	9.8	7.8	91.7	91.7	90	0.77	0.70	0.59	380	82	65.6	290	K
			1150	254T	10.6	8.5	91	90.1	88.9	0.73	0.69	0.56	240	66	53	210	H
	10	7.5	3480	215T	11.6	9.2	90.2	91	90.2	0.90	0.89	0.79	240	90	72	500	J
			1750	215T	13.2	10.5	91.7	91.8	90.7	0.78	0.75	0.65	270	92	73.6	380	J
			1170	256	13.7	11	91	91.2	90.2	0.75	0.74	0.63	270	93	75	200	J
	15	11	3520	254	17	13.6	91	91.3	91	0.89	0.87	0.83	200	109	87.2	340	G
			1760	254	17.8	14.2	92.4	92.2	91	0.84	0.80	0.71	210	121	96.8	240	H
			1170	284	19.3	15.4	91.7	91.3	89.7	0.80	0.71	0.59	350	135	108	250	J
	20	15	3515	256	22.2	17.7	91	91.5	91	0.93	0.91	0.89	160	133	106.4	340	F
			1755	256	23.3	18.6	93	93.5	93	0.87	0.84	0.77	210	152	121.6	250	H
			1170	286	25.7	20.6	91.7	91.7	90.6	0.80	0.78	0.66	340	188	151	230	J
	25	18.5	3535	284	27.2	21.7	91.7	92.5	91.9	0.93	0.92	0.88	150	170	136	200	F
			1765	284	27.9	22.3	93.6	94	93.7	0.89	0.87	0.80	180	173	138.4	260	F
	30	22	3525	286	32.4	25.9	91.7	92	91.7	0.93	0.88	0.85	150	185	148	200	E
			1760	286	33.9	27.1	93.6	94	93.8	0.87	0.85	0.78	190	207	165.6	270	F

**CONNECTION DIAGRAM  
(Across-The-Line Starting)**

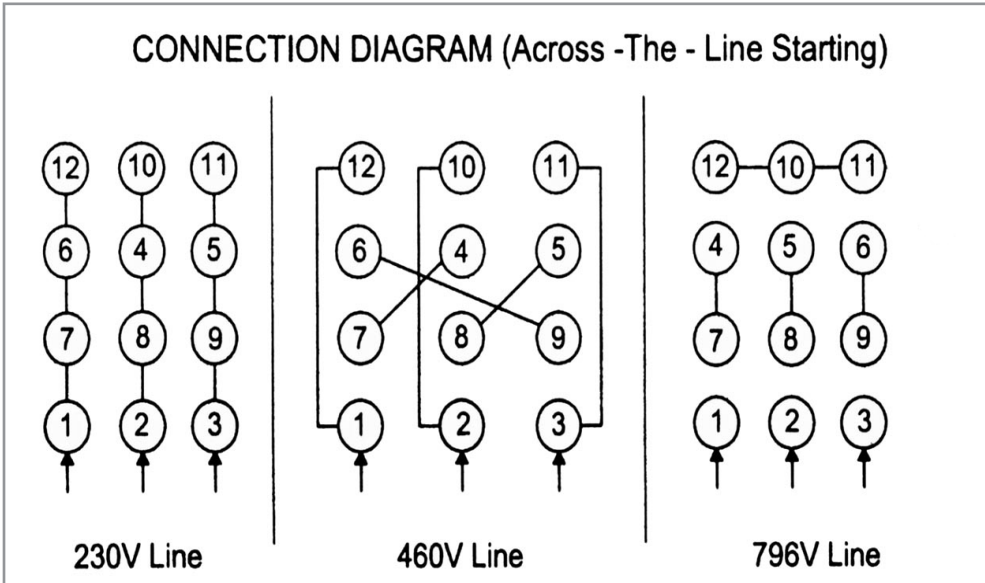
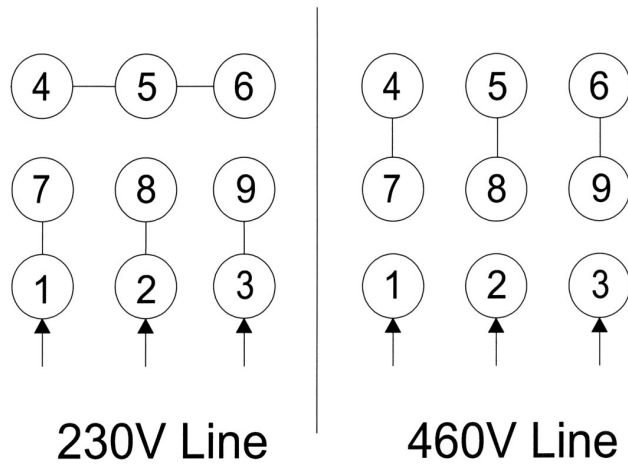

**CONNECTION DIAGRAM  
(Across-The-Line Starting)**

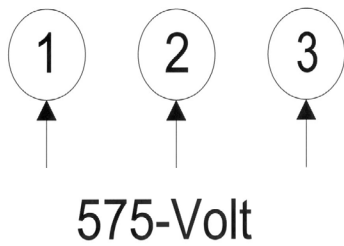

**CONNECTION DIAGRAM  
(Across-The-Line Starting)**

