

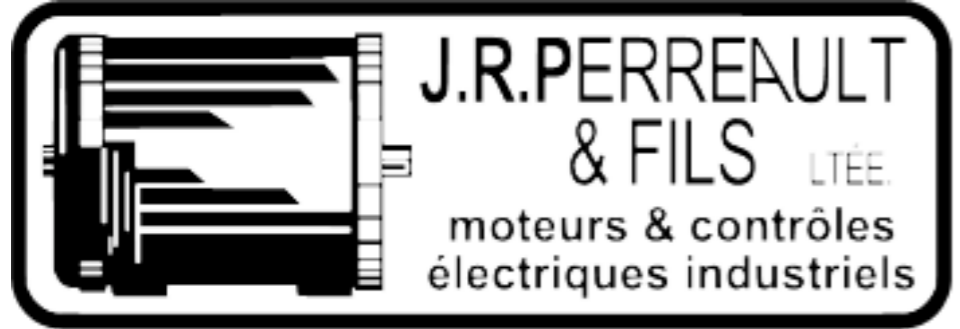

CRUSHER-MAX SERIES



TELEPHONE: 1-800-463-0400

www.jrperreault.com

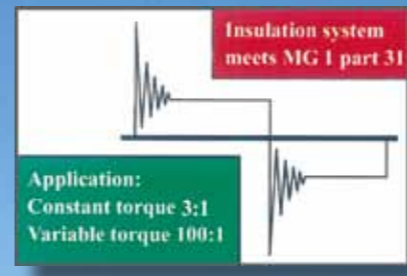

**FRAME 445T-N5810UZ
HORIZONTAL
TOTALLY ENCLOSED FAN COOLED**

ROCK CRUSHER DUTY MOTOR
MEETS EISA 2007
125HP TO 600HP
1800RPM, 1200RPM, 900RPM
NEMA DESIGN C



STANDARD FEATURES

- Class F Insulation
- Service Factor 1.15
- B Rise (80°C) at rated load
- NEMA Design C Torque
- Enclosure TEFC (IP55)
- Max. 40°C Ambient Temperature
- F1 Mounting
- Cast Iron Frame and T-box
- Heavy Duty Steel Plate Fan Cover
- Inpro Seal on Drive End
- High Strength Steel Shaft Material ANSI 4140
- CSA Approved
- Across-the-line and Y-Delta Start Capability
- Bearing Lock Nuts on both sides of shaft and vertical (VSI) Application
- Inverter Rated, Meets NEMA MG1 Part 31

OPTIONS

- Class H Insulation
- Corrosion Resistant Epoxy Finish Paint
- Cast Iron Fan Cover (#447TZ and Below)
- Bearing Temperature Detectors
- F2 Assembly Available
- Space Heater
- Thermostats
- SPM Adapter
- 575V (Model No. WCxxxxHFHT)

PERFORMANCE DATA

HP	Full Load RPM	NEMA Frame	MODEL NUMBER	Full Load CURRENT(A) (460V)	TORQUE		FULL LOAD EFFICIENCY (%)	POWER FACTOR (%)
					LOCKED ROTOR (%)	BREAK DOWN (%)		
125	1775	445T	WC1256HFIT	156	220	260	94.1	80.0
	875	505UZ	WC1258HFIT	165	210	240	93.6	76.0
150	1770	445T	WC1504HFIT	176	220	240	95.0	84.0
	1180	447TZ	WC1506HFIT	183	200	240	95.0	81.0
200	875	505UZ	WC1508HFIT	198	210	250	93.6	76.0
	1775	447TZ	WC2004HFBT	232	220	255	95.0	85.0
250	1180	505UZ	WC2006HFBT	244	210	230	95.0	81.0
	880	5806/7UZ	WC2008HFBT	269	205	235	94.1	74.0
300	1780	505UZ	WC2504HFBT	294	200	255	94.1	85.0
	1185	5806/7UZ	WC2506HFBT	304	200	230	95.0	81.1
350	880	5806/7UZ	WC2508HFBT	337	205	235	94.0	73.9
	1785	5806/7UZ	WC3004HFBT	346	200	235	95.0	85.5
400	1175	5806/7UZ	WC3006HFBT	365	205	235	95.0	81.0
	1785	5806/7UZ	WC3504HFBT	404	200	235	95.4	85.5
450	1175	5806/7UZ	WC3506HFBT	424	205	235	95.0	81.5
	1785	5806/7UZ	WC4004HFBT	458	200	235	95.0	86.1
500	1175	N5807/8UZ	WC4006HFBT	481	200	230	95.0	82.0
	1785	N5807/8UZ	WC4504HFBT	516	205	235	95.0	86.0
600	1175	N5807/8UZ	WC4506HFBT	541	200	230	95.0	82.0
	1785	N5807/8UZ	WC5004HFBT	573	205	240	95.0	86.0
600	1175	N5810UZ	WC6006HFBT	720	200	230	95.0	82.1

- Notes:
1. The above are typical values based on test per IEEE-112 method B (250HP & below) or method F/F1.
 2. 230/460V for Model NO. WCxxxxHFIT, 460V only for Model No. WCxxxxHFHT.
 3. All data subject to change without notice.
 4. Meets NEMA MG-1 Part 31.

TYPICAL NAMEPLATE

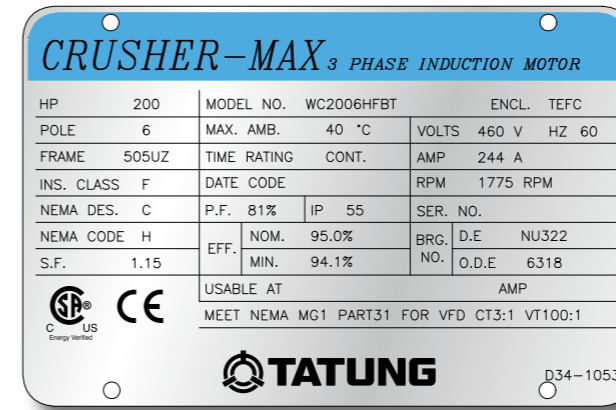

Leads

	Up to 150HP	200HP and larger	Optional for all ratings
	1800/1200/900 (RPM)	1800/1200/900 (RPM)	1800/1200/900 (RPM)
Volt	230/460	460	575
Lead	12	6	6
D.O.L.	YES	YES	YES
Y-Δ	YES	YES	YES

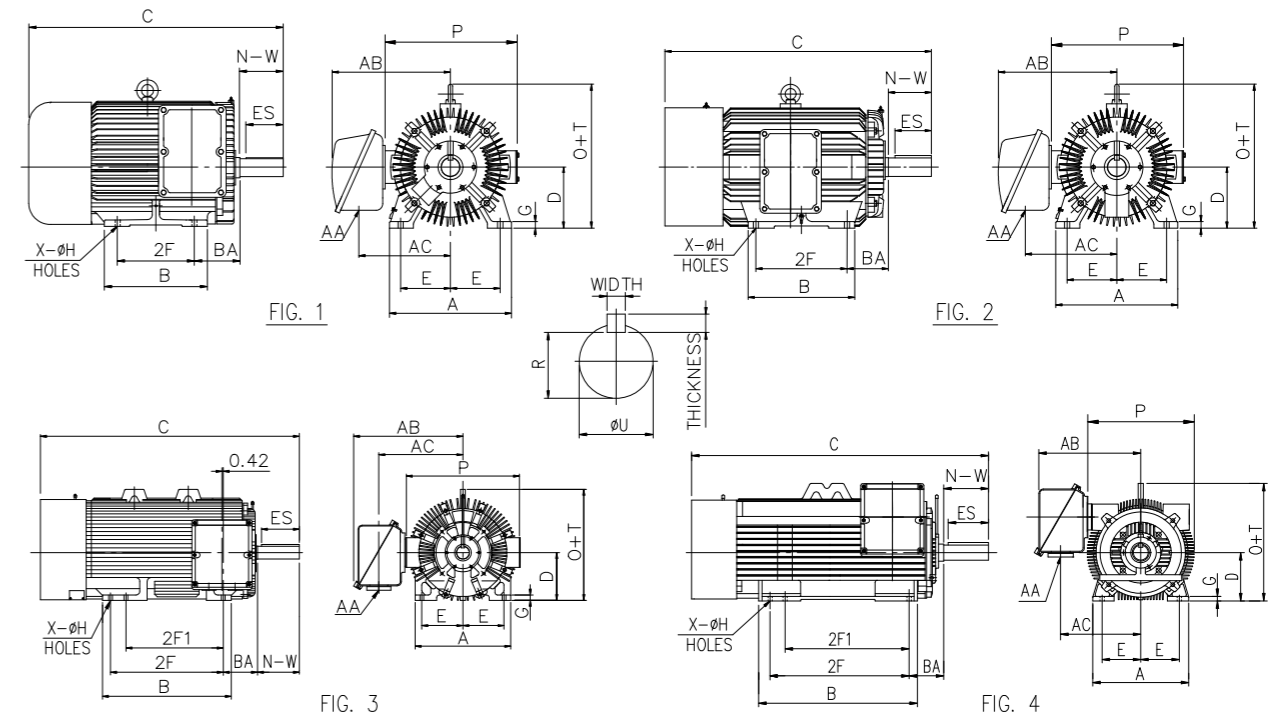

Unit : Inch

FRAME	FIG.	MOUNTING				BA	A	B	C	D	G	P	O+T
		2E	2F	2F1	X-φH								
445T	1	18.00	16.50	--	4-0.81	7.50	22.05	19.29	48.10	11.00	1.18	25.83	26.54
447TZ	2	18.00	20.00	--	4-0.81	7.50	22.05	22.83	59.54	11.00	1.18	26.77	27.83
505UZ	2	20.00	18.00	--	4-0.94	8.50	24.80	20.87	56.12	12.50	1.48	26.77	30.20
5806/7UZ	3	23.00	25.00	22.00	6-1.10	10.00	28.00	29.72	71.02	14.50	1.57	33.00	33.20
N5807/8UZ	4	23.00	28.00	25.00	6-1.10	10.00	28.00	33.85	76.69	14.50	1.53	33.28	34.20
N5810UZ	4	23.00	36.00	32.00	6-1.10	10.00	28.00	41.85	84.10	14.50	1.53	32.28	34.20

FRAME	CONDUIT BOX			KEY			R	SHAFT		BEARING NO.		APPROX. WEIGHT (lb)
	AA	AB	AC	WIDTH	THICKNESS	ES		N-W	U	D.E.	O.D.E.	
445T	1-NPT3"	22.24	17.32	0.875	0.875	6.875	2.880	8.50	3.375	NU220	6315	1800
447TZ	1-NPT3.5"	22.95	18.03	0.875	0.875	8.500	2.880	10.125	3.375	NU220	6315	2150
505UZ	1-NPT4"	21.85	17.44	1.000	1.000	10.00	3.309	11.625	3.875	NU322	6318	2700
5806/7UZ	2-NPT3"	30.94	23.86	1.000	1.000	10.00	3.817	11.625	4.375	NU324	6320	5280
N5807/8UZ	2-NPT3"	32.05	24.84	1.000	1.000	10.00	3.817	11.625	4.375	NU324	6320	5390
N5810UZ	2-NPT3"	32.05	24.84	1.000	1.000	10.00	3.817	11.625	4.375	NU324	6320	6600

Note:
Frame 5806UZ & 5807UZ, N5807UZ & N5808UZ have the same weight and mounting dimensions